

Office COPY

B/Spl. Bldg. 45/2003  
Planning Per. No. 19670/2002

**APPROVED**  
SUBJECT TO THE CONDITIONS IN THIS OFFICE LETTER.  
No. 19670/2002  
Date 01-2003

FOR MEMORANDUM SECRETARY  
CHENNAI METROPOLITAN  
DEVELOPMENT AUTHORITY  
CHENNAI-600 008.

PLAN SHOWING THE PROPOSED RESIDENTIAL BUILDING AT DOBR No.15/6B & 17/7B, 2nd CROSS STREET, KASTURIBA NAGAR, ADYAR, CHENNAI-20. IN T.S. No. 29 & 30, BLOCK No. 39, IN 115, KOTTUR VILLAGE, CORP DIVN No. 151, ZONE-X.

NOTE:-  
SUB DIVISION SANCTIONED WIDE REFERENCE PPA No. D10 / 14 / 2002, DATED - 2 / 4 / 2002.

AREA'S

PLY AREA	6925.45	643.37
MAX F.S.I.	10368.20	965.05
TYPICAL FLOOR	0.854.88	079.42
1st, 2nd & 3rd	9514.41	883.92
TOTAL	10369.29	963.34
NON F.S.I.	0954.19	088.65
CAR PARKING	0740.50	068.75
PROVIDED 1:49		
D.P. COVERAGE 45.79%		

SCHEDULE OF JOINERIES.

ED	ENTRANCE DOOR	3'6" x 7'0"
D	DOOR	3'0" x 7'0"
D1	DOOR	2'6" x 7'0"
FD	FRENCH DOOR	7'0" x 7'0"
D1W	DOOR CUM WINDOW	6'6" x 7'0"
DW1	DOOR CUM WINDOW	6'6" x 7'0"
W	WINDOW	6'0" x 6'0"
W1	WINDOW	4'6" x 6'0"
V	VENTILATOR	3'0" x 2'6"
O	OPENING	3'0" x 7'0"
D1W2	DOOR CUM WINDOW	6'0" x 7'0"

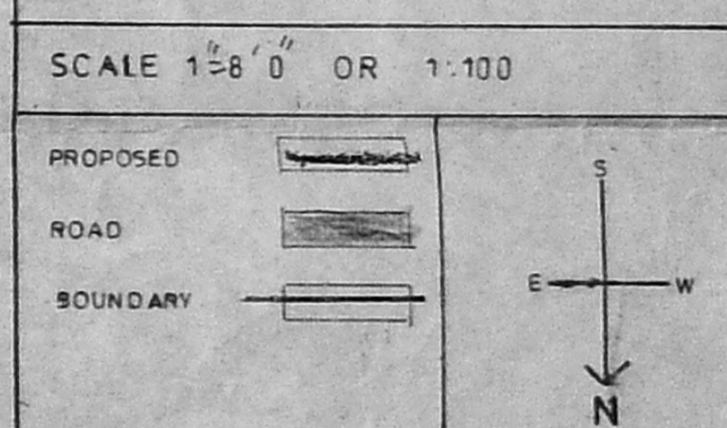

OWNER(S)

**S. ATHIVAMAN, B.E.**  
CHARTERED ENGINEER  
Class-I, Licensed Surveyor - No.192  
Incorporation of Chennai Corporation of Chennai  
Chennai - 17, Mobile: 88410-71245.  
LICENSED SURVEYOR